

Fixing Sockets Schroeder System

with crosshole and flat end



List
21

Dimensions [mm]					Approx. weight per 100 pieces [kg]	Permissible load with 4-fold/5-fold safety factor in kg [1 kg = 10 N, 1000 kg = 1 t = 10 kN]			
d x L	Reference No.	g	s	e		axial 0°	inclined pull up to 30°	inclined pull up to 45°	inclined pull up to 90°
M 6 x 35	k2109bk/zn	6	15	6.3	0.80	150	120	90	50
M 8 x 40	k2115bk/zn	8	15	8.3	1.05	240	200	150	100
M 8 x 53	k2117bk/zn	8	28	8.3	1.38	240	200	150	100
M 10 x 45	k2124bk/zn	10	15	10.3	1.50	290	230	170	100
M 10 x 57	k2127bk/zn	10	25	10.3	2.00	290	230	170	100
M 10 x 57	k2135bk/zn	10	24	10.3	3.00	450	400	300	250
M 12 x 55	k2139bk/zn	12	20	12.3	2.60	440	370	250	150
M 12 x 78	k2141bk/zn	12	43	12.3	4.00	600	500	400	350
M 12 x 62	k2149bk/zn	12	25	12.3	4.03	600	500	400	350
M 14 x 80	k2155bk/zn	13	33	12.3	6.16	600	500	450	400
M 14 x 100	k2156bk/zn	13	53	12.3	8.10	600	500	450	400
M 16 x 80	k2161bk/zn	15	30	12.3	9.82	1300	1100	900	800
M 16 x 100	k2162bk/zn	15	50	12.3	11.53	1300	1100	900	800
M 16 x 120	k2163bk/zn	15	70	12.3	14.65	1300	1100	900	800
M 20 x 95	k2171bk/zn	18	35	14.3	16.50	1700	1500	1300	900
M 20 x 115	k2172bk/zn	18	55	14.3	20.00	1700	1500	1300	900
M 24 x 120	k2181bk/zn	21	40	14.3	28.60	2000	1700	1500	1000
M 27 x 135	k2185bk/zn	22	47	17.3	49.60	2700	2300	2100	1200
M 30 x 150	k2187bk/zn	23	65	17.3	68.60	3900	3200	2500	1300

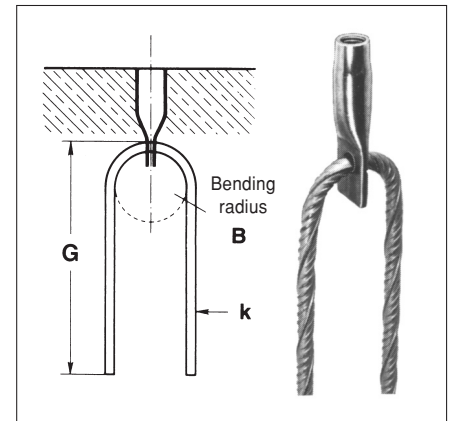
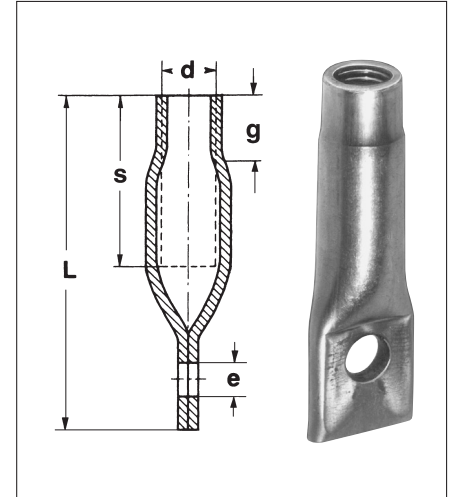

★ The specified loads can be achieved when using U-shaped reinforcing bars in the following dimensions

[mm]			
d	Ø k	B	G
M 10	8	60	250
M 12	10	60	300
M 14	10	70	300
M 16	10	70	350
M 20	12	80	400
M 24	12	80	450
M 27	14	100	500
M 30	14	100	600

Permissible loads have been determined by way of pull-out tests in axial, inclined, and transverse direction from C 20/25 (B 25) unreinforced concrete. A 4-fold/5-fold safety factor is allowed for in the above figures.

On your request our fixing sockets come with 4 to 6 µm electro plating plus yellow cromate coating.

Special designs on request

10/2006/WW



Friedrich Schroeder GmbH & Co. KG

58809 Neuenrade, Germany · Fon +49 (0) 23 94 / 91 80-0 · Fax +49 (0) 23 94 / 91 80-88
info@schroeder-neuenrade.de · www.schroeder-neuenrade.de