

# Eyebolts (DIN 580)

without link  
for lifting and transporting



List  
**43**

Dimensions [mm]							Permissible load in kg [1 kg = 10 N, 1000 kg = 1 t = 10 kN] axial
d	Ref. No.	Ref. No.	a	i	h	g	
M 8	<b>k4308bk</b>	<b>k4308zn</b>	36	20	36	13	140
M 10	<b>k4310bk</b>	<b>k4310zn</b>	45	25	45	17	230
M 12	<b>k4312bk</b>	<b>k4312zn</b>	54	30	53	20.5	340
M 14	<b>k4314bk</b>	<b>k4314zn</b>	63	35	62	27	450
M 16	<b>k4316bk</b>	<b>k4316zn</b>	63	35	62	27	700
M 20	<b>k4320bk</b>	<b>k4320zn</b>	72	40	71	30	1200
M 24	<b>k4324bk</b>	<b>k4324zn</b>	90	50	90	36	1800
M 27	<b>k4327bk</b>	<b>k4327zn</b>	90	50	90	36	2400
M 30	<b>k4330bk</b>	<b>k4330zn</b>	108	60	109	45	3600

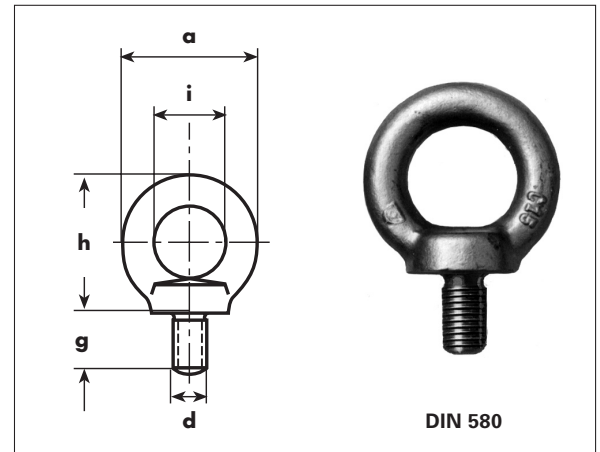

# Connection Loop

for joining precast panels



List  
**53**

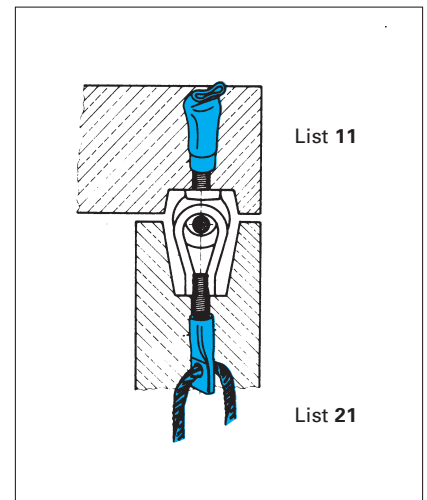
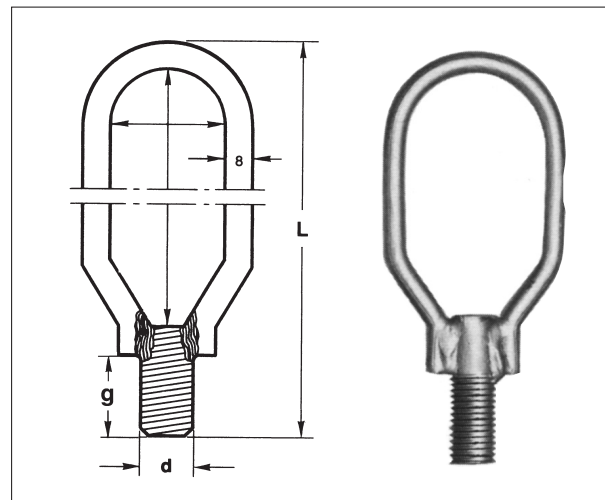

Dimensions [mm]					Approx. weight per 100 pieces [kg]	Permissible load with 4-fold/5-fold safety factor in [kg] [1 kg = 10 N, 1000 kg = 1 t = 10 kN] axial
d x L	Ref. No.	Ref. No.	inside dimension width x height	length of thread g		
M 10 x 100	<b>k5310bk</b>	<b>k5310zn</b>	34 x 65	15	9.60	750
M 12 x 100	<b>k5315bk</b>	<b>k5315zn</b>	34 x 65	20	11.40	900
M 12 x 125	<b>k5320bk</b>	<b>k5320zn</b>	45 x 85	20	12.80	900
M 16 x 120	<b>k5325bk</b>	<b>k5325zn</b>	45 x 55	30	16.00	1000
M 16 x 140	<b>k5330bk</b>	<b>k5330zn</b>	45 x 85	30	18.00	1000
M 16 x 175	<b>k5335bk</b>	<b>k5335zn</b>	45 x 130	30	20.00	1000
M 16 x 235	<b>k5340bk</b>	<b>k5340zn</b>	45 x 180	30	25.00	1000

Example:  
Joining two non-load bearing internal walls

Connection loops produce a static connection for joining prefabricated concrete elements. They are also used for additional partitions.

The standard production part comes with two single-fillet weldings. Double-fillet weldings are available as an option at extra charge.